

MADISON



MODEL 29 - 20

www.nuvistahomes.com

Total: 2040 sq. ft.



- 9' main floor
- 3 bedrooms, 2.5 bathrooms
- Kitchen offers a great island and corner pantry
- Main floor flex room
- Centrally located bonus room
- Master bedroom has a 5 piece ensuite with a large walk in closet
- Upper floor laundry is spacious and has built-in linen storage.



WIDTH: 24'
MODEL 29 - 20

MADISON

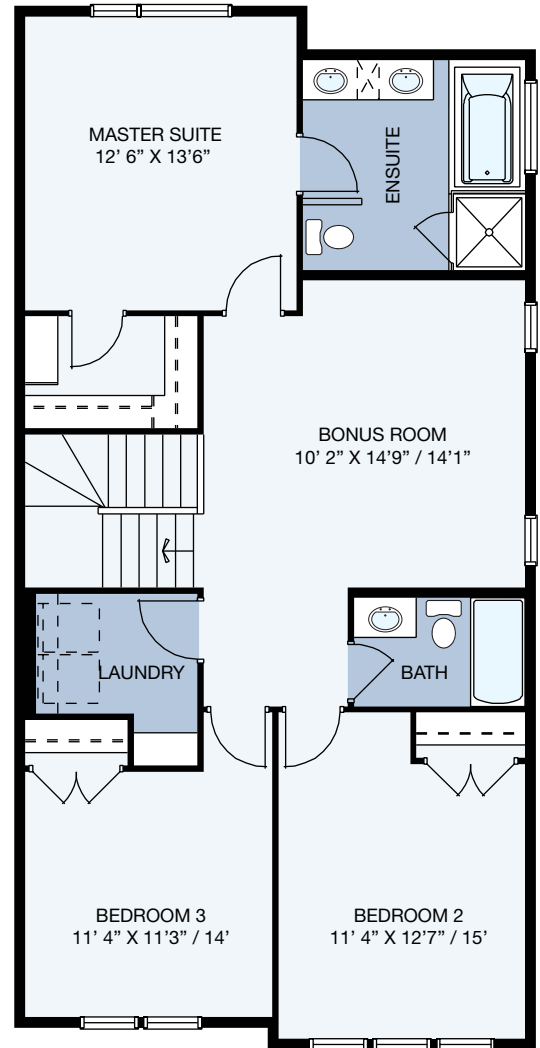
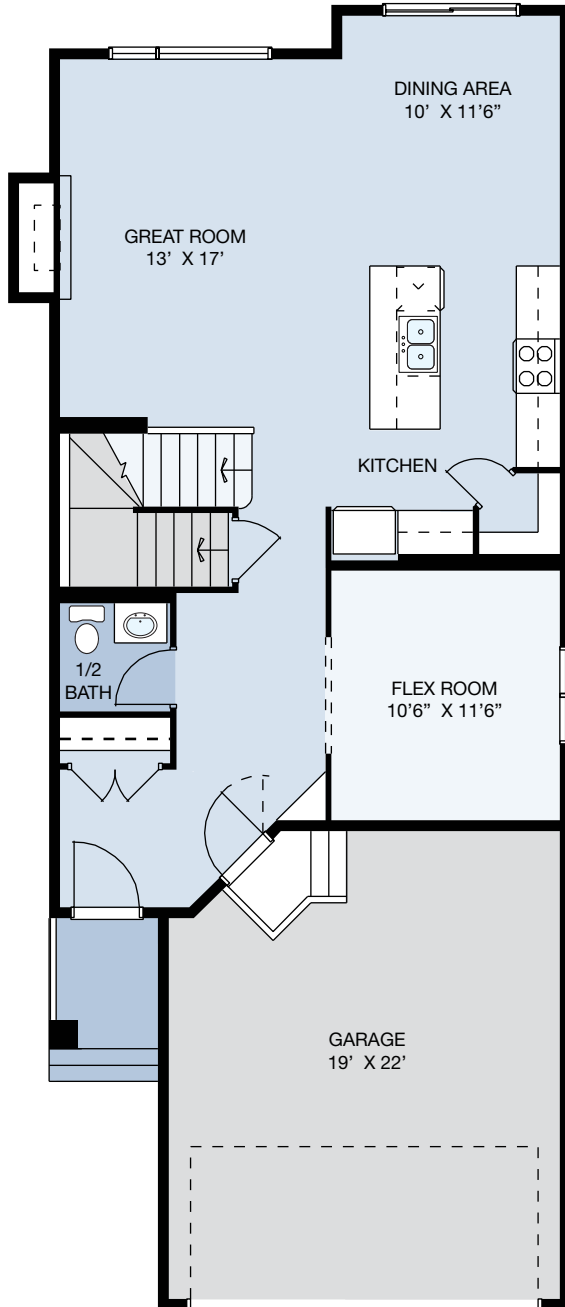

MAIN LEVEL: 921 sq.ft. UPPER LEVEL: 1119 sq.ft. TOTAL: 2040 sq.ft.
info@nuvistahomes.com • www.nuvistahomes.com

*Based on one elevation, refer to blueprint for elevation specific floorplans. The design is published by NuVista Homes and is subject to change without notice. All rights reserved, including the rights of reproduction in whole or in part in any form. NuVista reserves the right to change specification and plan without notice, however, guarantees that change will be of greater value. Room dimensions are approximate.